

Parts kit No. HT

No.	PN.	Parts No.	Description	Q'TY	Specification	No.	PN.	Parts No.	Description	Q'TY	Specification
155	HT9	HT9001A-1	Tail linkage rod	1	φ2X250mm	114	HT2	HS1002	Self tapping screw	4	M2X6
156	HT9	HT9001C	L-type linkage rod	1	φ1.3X16mm	115	HT2	HS1003	Self tapping screw	2	M2X8(φ3.4head)
157	HT9	HT9001B	Linkage rod(B)	1	φ1.3X12.5mm	116	HT3	HT3001	Vertical stabilizer	1	
158	HT9	HT7001A	Ball link (short)	1		117	HT3	HT3002	Horizontal stabilizer	1	
111	HT2	HT2002	Tail servo mount	2		118	HT3	HT3003	Bracket	1	
112	HT2	HT2003A	Tail boom brace terminal	4		119	HT3	HS1002	Screw	2	M2X6
113	HT2	HT2003B	Tail boom brace	2	φ3X205mm						

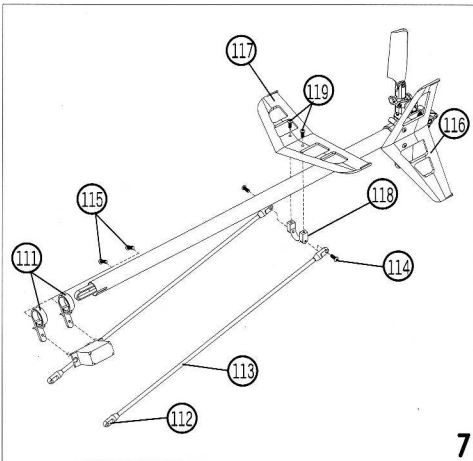

7

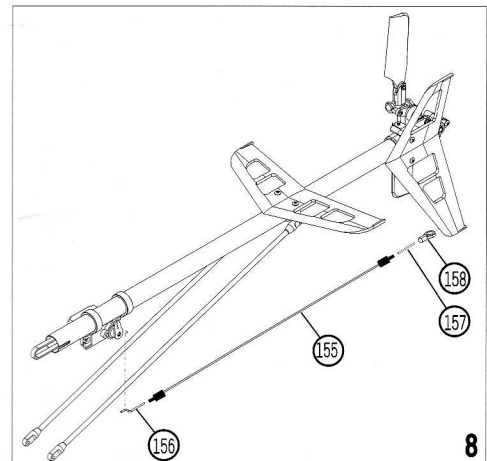

8

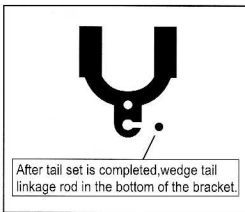
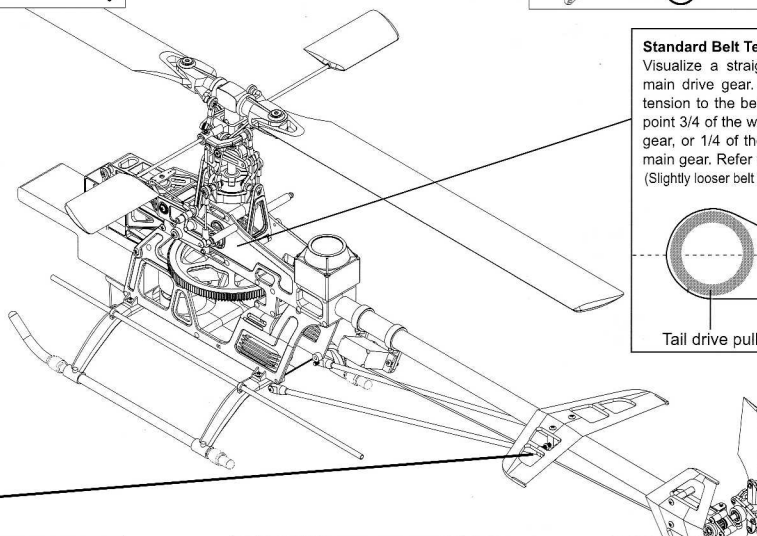

Standard Belt Tension Guide:
 Visualize a straight line through the center of the main drive gear. You should be able to apply light tension to the belt with your finger until it reaches a point 3/4 of the way to the opposite edge of the main gear, or 1/4 of the way past the virtual center of the main gear. Refer to photo.
 (Slightly looser belt tension will provide slightly more power.)

Tail drive pulley Middle Belt

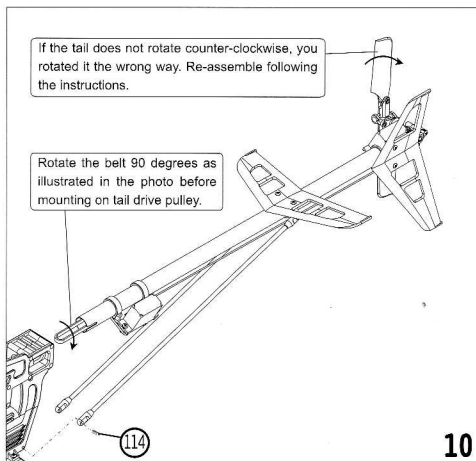

10

Aileron

Elevator

Throttle

Rudder

Pitch

ESC

Gyro

Adjustment signal line

6 channel receiver

6-Channel Receiver is adequate for the requirements of the T-REX heli. You will need the following channels at a minimum: Throttle, Rudder, Elevator, Ailerons, and especially Pitch and Gyro (Ch5) controls.

9

ASSEMBLING STEPS

ALIGNRC

PARTS AND EQUIPMENT ASSEMBLY ILLUSTRATION

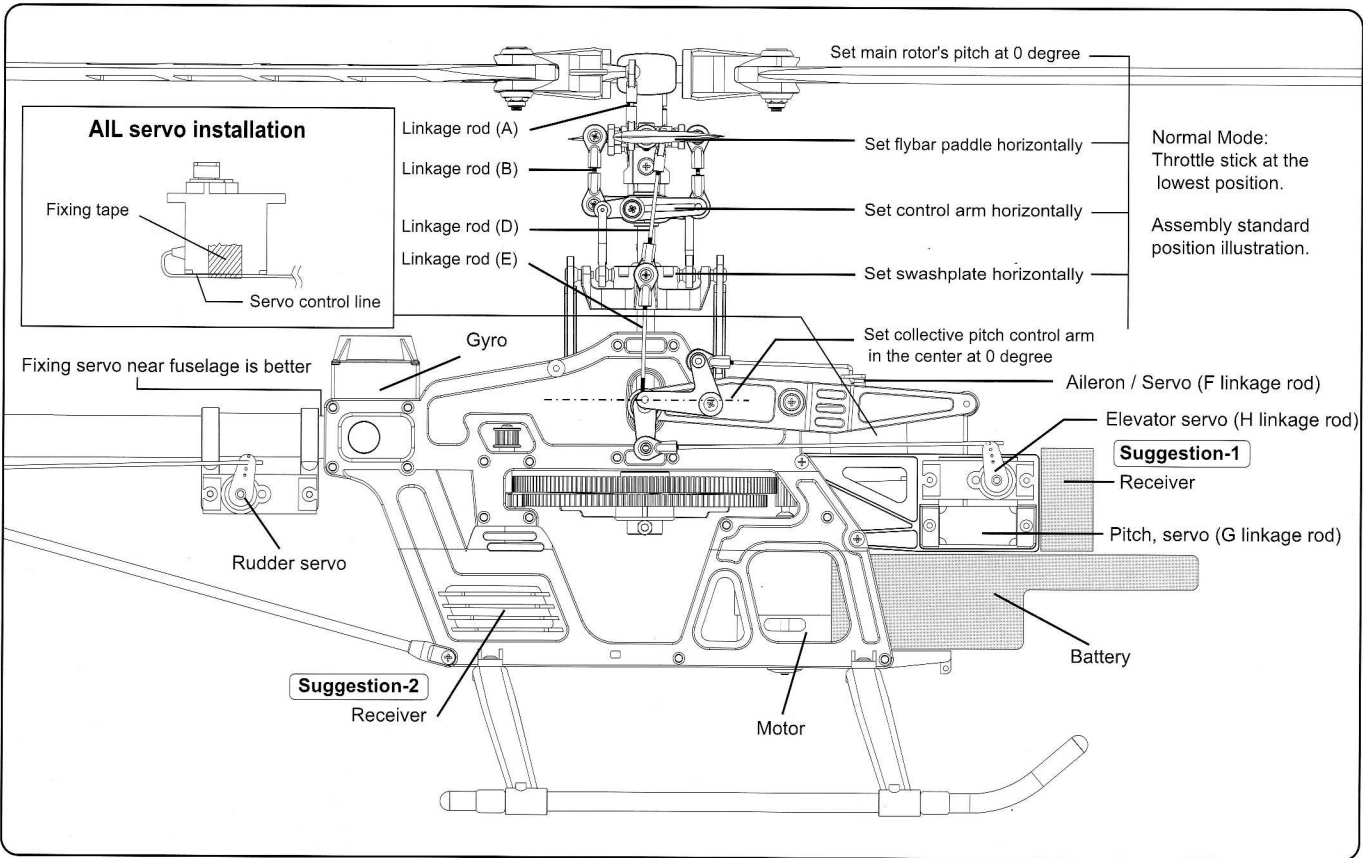

FINAL PRE-FLIGHT ADJUSTMENTS

Note !

1. Pitch range: 21°
2. If the pitch is set too high, it will result in shorter flight duration and poor motor performance.
3. Setting the throttle to provide a higher speed is preferable to increasing the pitch too high.

Hovering Flight

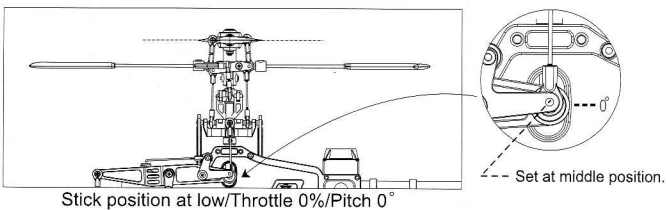
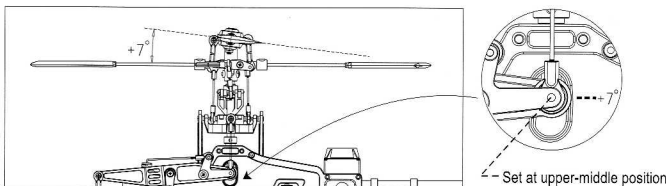
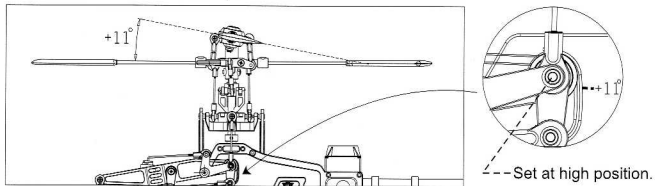

3D Flight

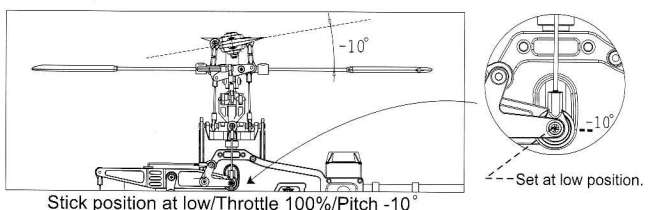
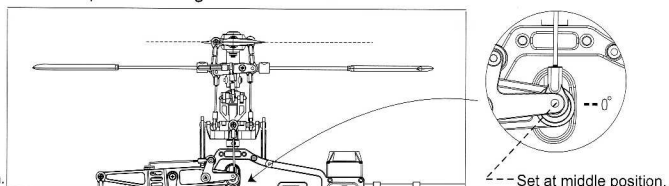
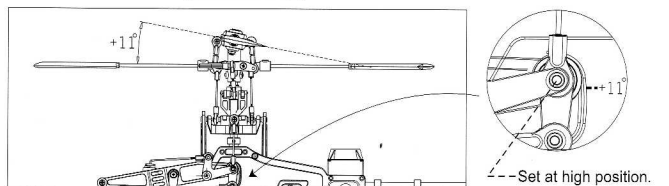

Throttle	Pitch
5 100% High speed	$+9^\circ \sim +11^\circ$
4 85%	
3 70% Middle speed (Hovering)	$+6^\circ \sim +7^\circ$
2 45%	
1 0% Low speed	0°

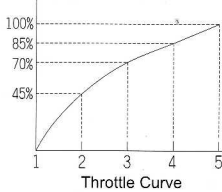

Throttle	Pitch
5 100%	$+9^\circ \sim +11^\circ$
4 85%	
3 75%	$+7^\circ$
2 60%	
1 60%	-4°

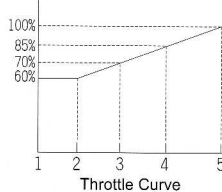

Throttle	Pitch
3 100% High speed	$+9^\circ \sim +11^\circ$
2 85% Middle speed	0°
1 100% Low speed	$+8^\circ \sim -10^\circ$

